

PARKING DETAIL
SCALE: 1" = 10'-0"

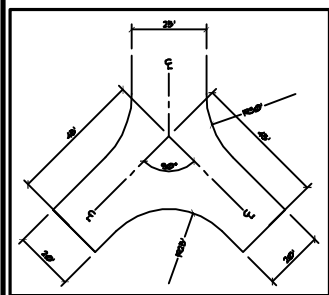

WYE TURN DETAIL
SCALE: 1" = 30'-0"

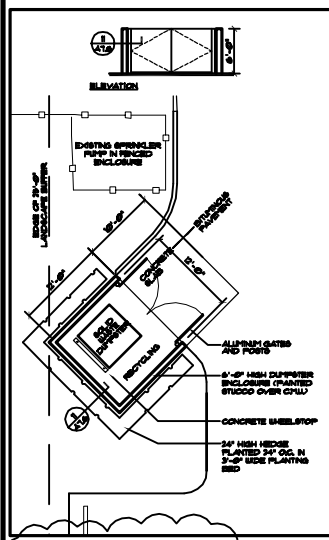

DUMPSTER DETAIL
SCALE: 1/8" = 1'-0"

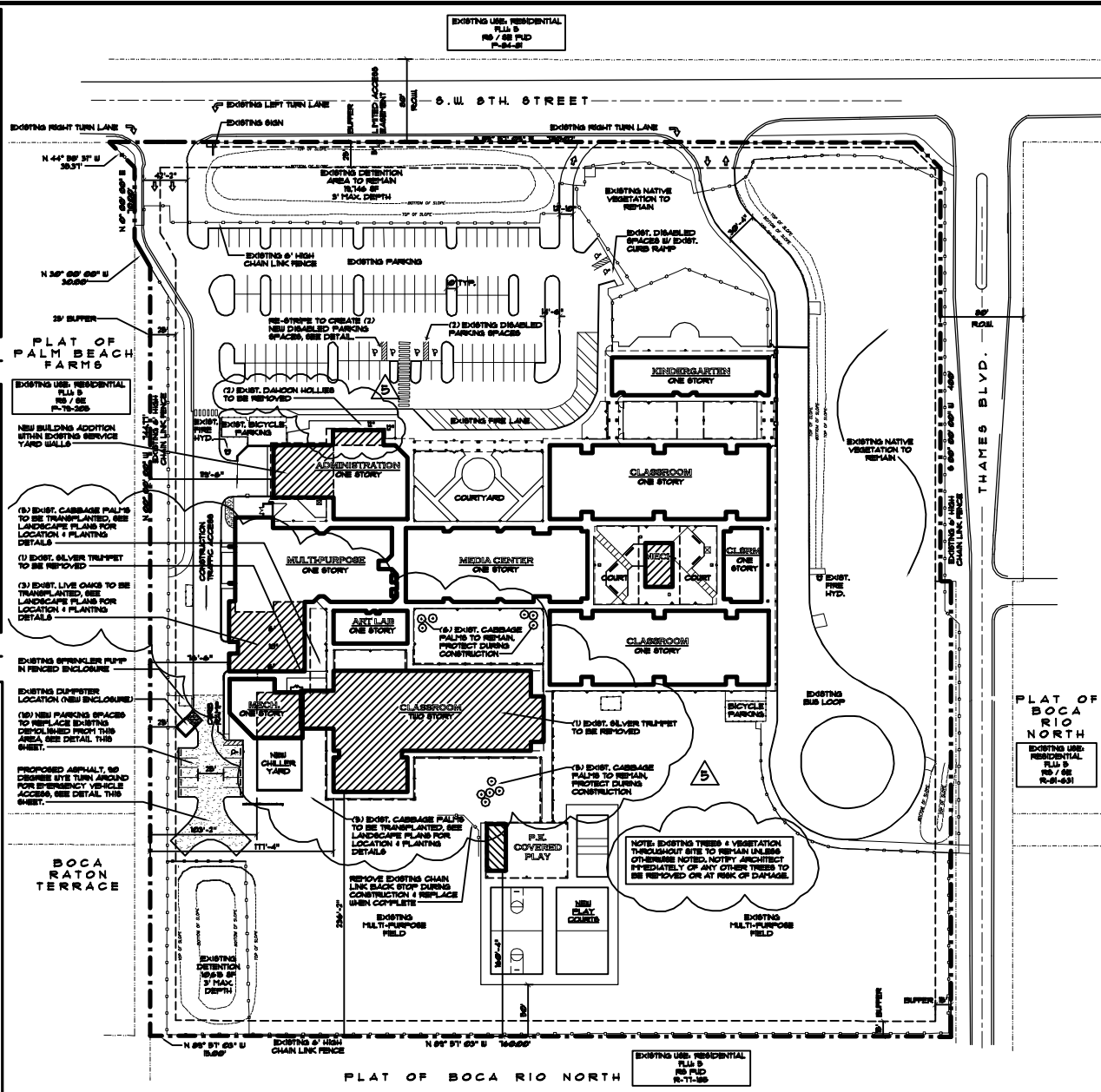

SITE PLAN
SCALE: 1" = 50'-0"

SITE DATA	
NAME OF PROJECT: SCHOOL 'U-3' HAMMOCK PONTE ELEMENTARY SCHOOL RENOVATION AND ADDITION	
PETITION NO. P-84-34(1) R-30-1001	
PROPOSED USE: ELEMENTARY SCHOOL	
TOTAL NUMBER OF STUDENTS: 634	
FUTURE LAND USE DESIGNATION: INST	
ZONING DISTRICT: RS / EE	
SECTION/DIVISION/PARCEL: 870 1210 1432	
PROPERTY CONTROL NUMBERS: 88-42-41-28-18-001-0000	
P.L.D.: BOCA RIO NORTH	
PARCEL/TRACT NAME: TRACT 'A' ELEMENTARY SCHOOL 'U-3'	
PLAT BOOK 'B', PAGE '14'	
VELOCITY ZONE: 140 MPH	
FLOOD ZONE: AO	
AREA CALCULATIONS	
TOTAL SITE AREA:	67,970 SF 0.34 ACRES
BUILDING AREA:	11,580 SF
EXISTING PROPOSED:	43,240 SF
TOTAL GROSS FLOOR AREA:	19,220 SF
FLOOR AREA RATIO:	0.28
EXISTING	
PERVIOUS AREA:	24,330 SF 36%
OPEN / PERVIOUS AREA:	43,230 SF 64%
PROPOSED	
PERVIOUS AREA:	38,600 SF 57%
BUILDING COVERAGE:	38,600 SF 57%
PARKING & DRIVEWAYS:	16,290 SF
PLAY COURTS:	16,290 SF
TOTAL:	27,874 SF 41%
OPEN / PERVIOUS AREA:	38,600 SF 57%
DETENTION AREA:	30,240 SF 45% .74 ACRES
BUILDING HEIGHT PROPOSED:	34'-0" MAX. AT 2 STORY PORTION
NOTE: BUILDINGS WILL BE EQUIPPED WITH AN AUTOMATIC FIRE SPRINKLER SYSTEM THROUGHOUT.	
PARKING	
REQUIRED:	STAFF (1 PER BACH) 87 SPACES
	VISITORS (1 PER 100 STUDENTS) 63 SPACES
TOTAL REQUIRED:	150 SPACES
PROVIDED:	EXISTING 136 SPACES
	NEW 14 SPACES
ACCESSIBLE:	14 SPACES
REQUIRED:	14 SPACES
PROVIDED:	14 SPACES

SITE LEGEND	
[Solid Line]	INDICATES EXISTING BUILDING
[Hatched Area]	INDICATES NEW BUILDING OR ADDITION
[Dotted Area]	INDICATES AREA OF NEW PAVEMENT. SEE CIVIL DRAWINGS FOR DETAILS

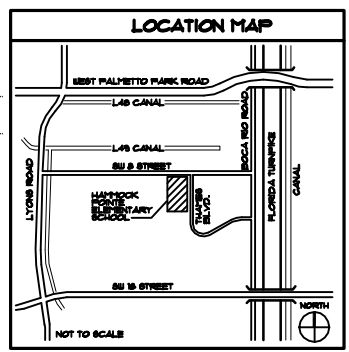

LOCATION MAP
NOT TO SCALE

DOW · HOWELL · GILMORE · ASSOCIATES, INC.
 ARCHITECTS INTERIORS PLANNERS
 8400 SW 8TH STREET BOCA RATON, FLORIDA
 PHONE: (305) 993-1100 FAX: (305) 993-1101
 WWW: WWW.DHGARCHITECTS.COM
 SCALE: 1" = 50'
 SHEET NO. 01
 DATE: 08/15/2023